

Sideways travel improves performance in applications with regular direction change

Ideal for loading and unloading of HGVs and for longer transport distances

Electric steering

High speed and acceleration improving productivity



## ESE 120/220/320

**Electric stand-on / sideways-seated pallet truck (2,000 kg)**

ESE 120/220/320 pallet trucks are ideal for horizontal transport over medium to long distances. With their sideways operator position, they offer excellent visibility and relaxed working conditions. This is a great advantage, especially where frequent changes of direction are required.

The width of the ESE 120 stand-on truck is only 760 mm, which is narrower than a Euro pallet. This allows for easy pallet positioning inside an HGV as well as for rapid loading and unloading. The fold-up seat offers additional comfort when travelling over longer distances. The low entry height assists frequent entry and exit.

The ESE 220 with 820 mm truck width and the ESE 320 with 930 mm width are side-seat trucks which offer your operators a high degree of comfort and are therefore ideal for long-distance transport. The adjustable foot-well height ensures a

relaxed working position for all operators.

All trucks are fitted with powerful 24 V drive motors for rapid acceleration and high top speeds. In addition they offer the advantages of a sturdy design: The frame and load sections are designed for capacities up to 2000 kg.

Other advantages:

- Rapid travel speeds and acceleration.
- Extremely durable frame for exceptionally high operational demands.
- Display with steering position display and travel program selection (optional for ESE 220 and 320).
- Electric steering for easy manoeuvring with a few turns of the steering wheel.
- Excellent energy management for low operating costs.

# ESE 120/220/320

ESE 120

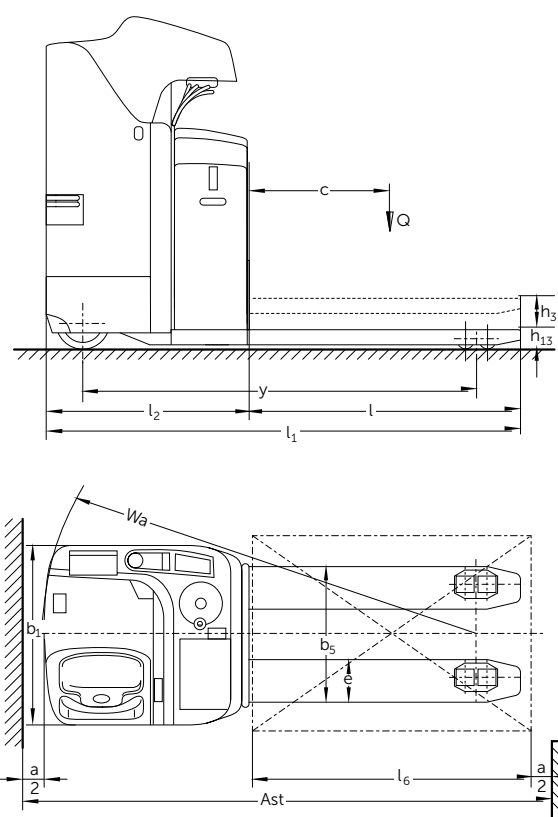

ESE 220/ 320

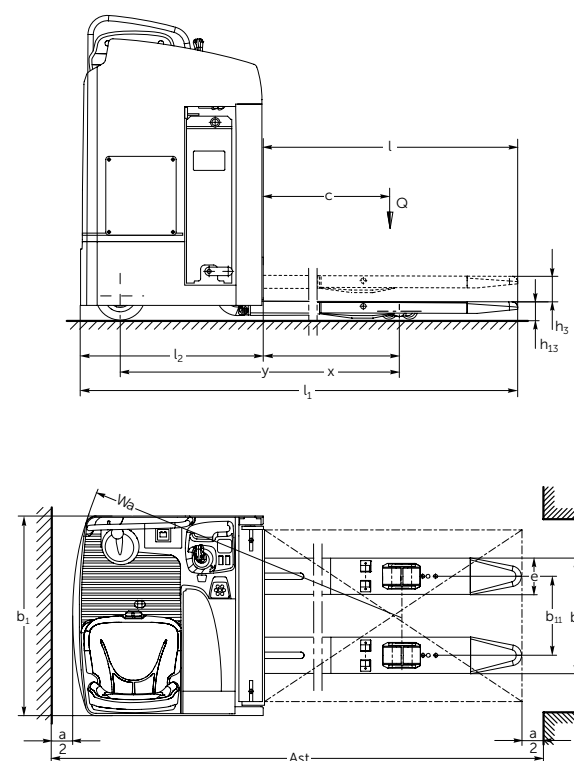

# Technical data in line with VDI 2198

Identification	1.1	Manufacturer (abbreviation)		Jungheinrich			
	1.2	Model		ESE 120	ESE 120	ESE 220	ESE 320
					Rapid drive		
	1.3	Drive		Electric			
	1.4	Manual, pedestrian, stand-on, seated, order picker operation		stand-on	stand-on	seat	seat
	1.5	Load capacity/rated load	Q t	2			
	1.6	Load centre distance	c mm	600			
	1.8	Load distance	x mm	964 <sup>4)</sup>	964 <sup>4)</sup>	868	868
	1.9	Wheelbase	y mm	1,595 <sup>2)</sup>	1,731 <sup>4)</sup>	1,535 <sup>4)</sup>	1,541 <sup>3)</sup>
Weights	2.1.1	Net weight incl. battery (see row 6.5)	kg	857	990	1,062	1,074
	2.2	Axle load with load front/rear	kg	1,840 / 1,017	1,900 / 1,090	1,896 / 1,142	1,902 / 1,182
	2.3	Axle load without load front/rear	kg	215 / 642	240 / 750	258 / 808	264 / 816
Wheels / frame	3.1	Tyres		Polyurethane			
	3.2	Tyre size, front	mm	Ø 230 x 78			
	3.3	Tyre size, rear	mm	Ø 85 x 85			
	3.4	Additional wheels (dimensions)	mm	Ø 140 x 54			
	3.5	Wheels, number front/rear (x = driven wheels)		2+1x/4	1+1x/4	2-1x/4	2-1x/4
	3.6	Tread width, front	b <sub>10</sub> mm	475	475	544	645
	3.7	Tread width, rear	b <sub>11</sub> mm	340 / 370 / 490	340 / 370 / 490	385	385
Basic dimensions	4.4	Lift	h <sub>3</sub> mm	125			
	4.8	Seat height/stand height	h <sub>7</sub> mm	0	0	1,020	1,020
	4.8.1	Standing height	h <sub>7</sub> mm	245	245	0	0
	4.15	Height, lowered	h <sub>13</sub> mm	90			
	4.19	Overall length	l <sub>1</sub> mm	2,024	2,096	2,009	2,009
	4.20	Length to face of forks	l <sub>2</sub> mm	874	946	859	859
	4.21	Overall width	b <sub>1</sub> /b <sub>2</sub> mm	760	760	820	930
	4.22	Fork dimensions	s/e/l mm	55 / 170 / 1,150	55 / 170 / 1,150	60 / 185 / 1,150	60 / 185 / 1,150
	4.25	Width across forks	b <sub>5</sub> mm	510 / 540 / 660	510 / 540 / 660	540	540
	4.32	Ground clearance, centre of wheelbase	m <sub>2</sub> mm	30	30	25	25
	4.34	Aisle width for pallets 800 x 1200 lengthways	Ast mm	2,274 <sup>1)</sup>	2,346 <sup>1)</sup>	2,197 <sup>1)</sup>	2,215 <sup>1)</sup>
	4.35	Turning radius	W <sub>a</sub> mm	1,838	1,910	1,665	1,683
Performance data	5.1	Travel speed, laden/unladen	km/h	8.5 / 10.5	9.5 / 12.5	10 / 12.5	10 / 12.5
	5.2	Lift speed, laden/unladen	m/s	0.04 / 0.05	0.04 / 0.05	0.06 / 0.07	0.06 / 0.07
	5.3	Lowering speed, laden/unladen	m/s	0.065 / 0.045	0.065 / 0.045	0.06 / 0.05	0.06 / 0.05
	5.8	Max. gradeability, laden/unladen	%	6 / 12	6 / 12	8 / 13	8 / 13
	5.10	Service brake		electric			
Electrics	6.1	Drive motor, output S2 60 min.	kW	2.0	2.5	2.8	2.8
	6.2	Lift motor, output at S3 15%	kW	2.0	2.0	1.5	1.5
	6.3	Battery as per DIN 43531 / 35/36 A, B, C, no		B	B	no	no
	6.4	Battery voltage/nominal capacity K5	V/Ah	24 / 375	24 / 500	24 / 465	24 / 465
	6.5	Battery weight	kg	297	370	380	380
Misc.	8.1	Type of drive control		SpeedControl	SpeedControl	AC Speed-Control	AC Speed-Control

<sup>1)</sup> Diagonal in accordance with VDI: + 188 mm

<sup>2)</sup> Load section lowered: +65 mm

<sup>3)</sup> Load section lowered: + 95 mm

<sup>4)</sup> Load section lowered: 90 mm

# Benefit from the advantages



ESE 120: Controls for speed regulation and lift function



ESE 120 stand-on truck with easily accessible controls and fold-up seat



All drive and lift functions controlled by the multi-functional joystick on the ESE 220/320



Comfortable seating position with height-adjustable footplate

## Innovative 3-phase AC technology

Better performance combined with reduced operating costs. Make use of these advantages (for ESE 220/320):

- High level of efficiency with excellent energy management.
- Powerful acceleration.
- Rapid change in direction of travel.
- No carbon brushes, maintenance-free drive motor.

## Productivity-enhancing ergonomics

The arrangement of the operator workstation, sideways to the direction of travel, ensures optimum visibility and reduces potential neck complaints due to frequent changes in direction. A safety switch in the footwell ensures maximum safety.

### ESE 120

- Fold-up seat acts as a backrest when the operator is standing.
- Footrest for better support when sitting.

### ESE 220/320

- Comfortable seat with adjustment for body weight.
- Padded armrest.
- Padded knee area.

## Comfortable and safe operation

Safe speed regulation with SpeedControl. SpeedControl ensures maximum safety and effortless control of speed in all situations.

- Roll-back protection on gradients with automatically activated brake.
- Constant travel speed on gradients/descents.
- Energy recovery with regenerative braking.
- Particularly smooth stepless operation.

## Easy operation and good all-round visibility

The central position of the operator within the enclosed truck contours means they are well protected and have optimum all-round visibility. The easy-to-operate electric steering and the easily accessible controls provide additional comfort:

### ESE 120:

- Speed regulation by drive switch.
- Lift function button can be operated without changing grip.
- Stable drive handle provides a secure grip when standing.

### ESE 220/320:

- Drive and lift control via multifunction lever.

## Powerful battery

### ESE 120

- Short battery compartment: 3 PZS 375 Ah.
- Long battery compartment: 4 PZS 500 Ah.

### ESE 220/320

- Lateral battery exchange.
- 3 PZS 465 Ah.
- Lateral battery exchange.

## Robustness and ease of servicing

- Easy access to the controller and electronics.
- Robust, enclosed frame.

## Additional equipment

- Different load wheels (depending on the application).
- Cold store version.
- Code lock.
- Steering wheel on the left (ESE 120).
- Load guard.
- Unloading and steering position display (optional on the ESE 220/320).

## Jungheinrich Lift Truck Ltd.

559/3-5 Moo 7  
Kingkaew-Bangplee Rd.  
Tambon Bangpleeyai  
Amphoe Bangplee  
Samutprakarn 10540  
Thailand  
Tel.: +66 2715 0305  
Fax: +66 2715 0309

info@jungheinrich.co.th

The German production facilities in Norderstedt, Moosburg and Landsberg are certified.

ISO 9001  
ISO 14001

Jungheinrich fork lift trucks meet European safety requirements.



**JUNGHEINRICH**  
Machines. Ideas. Solutions.